

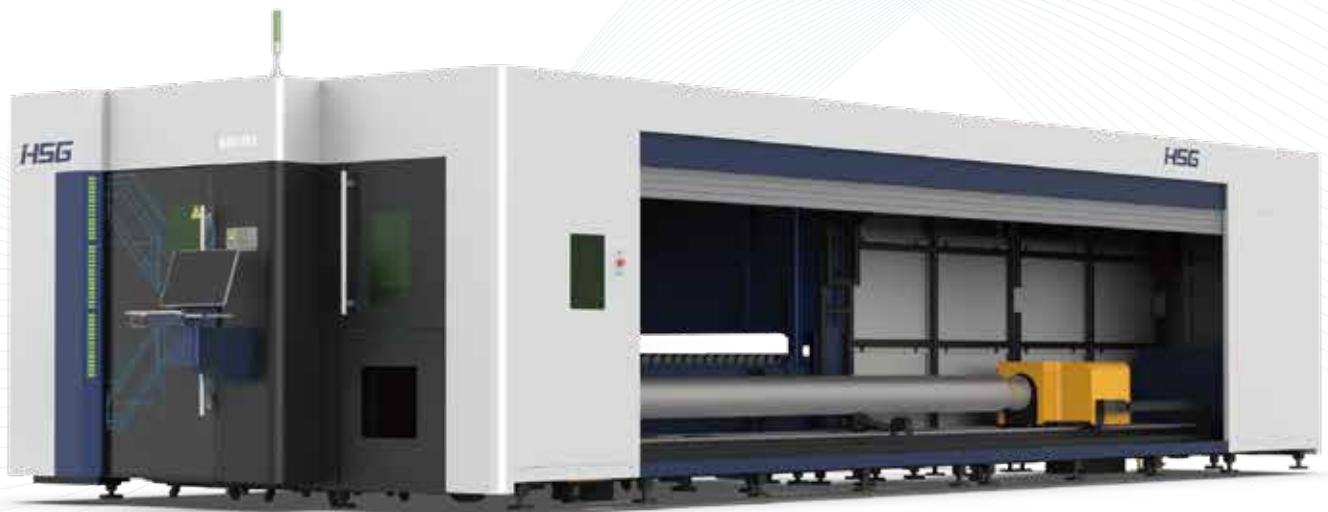

Cutting | Bending | Welding | Automation



GXE

✦ Double Exchange Platforms Sheet & Tube Laser Cutting Machine ✦

Company Culture

MISSION

Intelligent manufacturing changes future

VALUES

Customer-focused and employee-based

VISION

Become a respectable enterprise in the global metal forming equipment field

Company Profile



13

13 branches/subsidiaries/
sub-subsidiaries across the world



100+

Serve 100+countries and
regions



4

Manufacturing Bases in
China



30+

Global service outlets

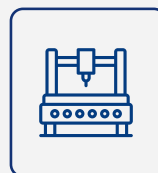

8000+Sets
of Annual Output



96000m²

Occupied Area



GXE 1500-6000W

Double Exchange Platforms Sheet & Tube Laser Cutting Machine

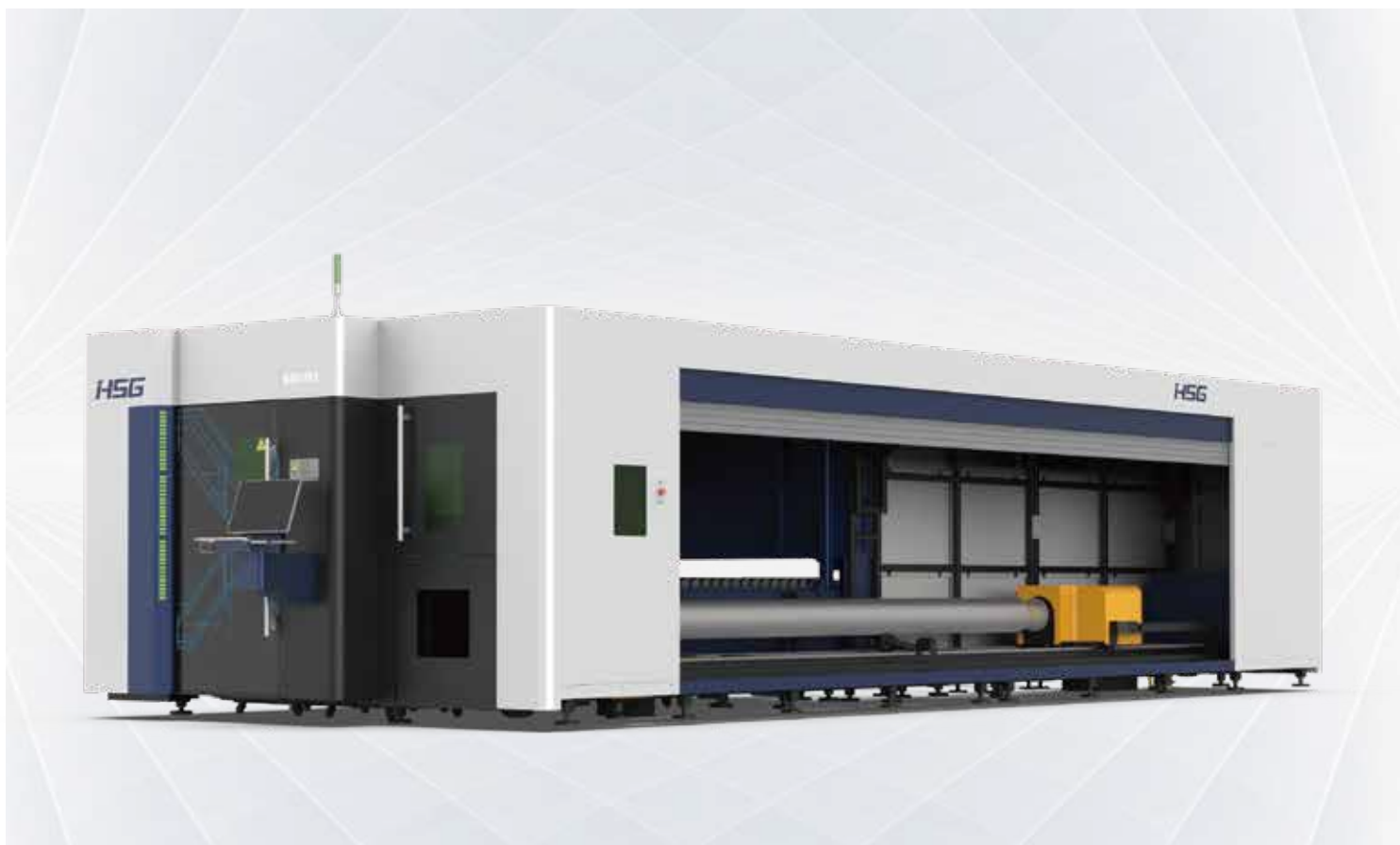

Technical Parameters

Technical Parameters	G3015XE
Power	1500W-6000W
Processing format (L*W)	3048mm*1524mm(10' *5')
X/Y-axis positioning accuracy	$\pm 0.03\text{mm/m}(\pm 0.00118'')$
X/Y-axis repositioning accuracy	$\pm 0.03\text{mm}(\pm 0.00118'')$
Acceleration	0.5G
No-load speed	60m/min

* Machine appearance, technical parameters, function description, data comparison shown in this page are from HSG in-house laboratory. All testing results and experimental data shall be subject to real machine.

HSG Bus-based Control System

- This system is easy to be operated and rich in functions.
- Even green hands can cut high-quality samples.
- Monitor core components in real time.
- Millisecond-level follow-up response technology.
- Click to create processing report.
- Compatible with codes of international brands.



Automatic Focus Cutting Head

- Autofocus Laser Cutting Head
The cutting head can adjust its focus according to laser beam mode to make sure of mirror-like surface.
- Servo autofocus system
- Automatic cooling and obstacle avoidance
- Three built-in protective lens
- Anti-pollution design
- Give early warning if abnormal

Professional Nesting Software (Optional)

- No matter sheet cutting or tube cutting, it is equipped with professional nesting software to optimize cutting track and improve efficiency.

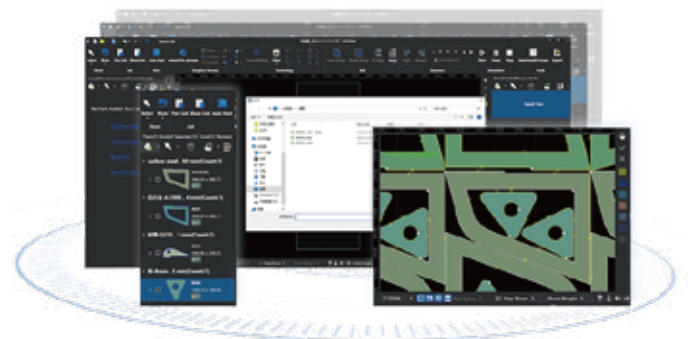



Exchange Platforms

- Achieve the cutting operation and loading and unloading synchronization.
- Before the switching motor, the rear workbench loading and unloading space is sufficient.
- The sheet metal cover is safe from damage.

Tube Splicing Technology

- The operating control offers 50+ kinds of tube splicing patterns, for convenience of subsequent welding, such as splicing of male and female head of square tube, 90° arc splicing, splicing of round tube tee, splicing of cut-through holes, 45° splicing of hexagon, splicing of angle iron and channel steel, etc.



Automatic Pneumatic Double Chucks

- Automatic centering the chucks.
- Pneumatic chuck clamping with large clamping force.
- Special support frame to avoid tube sagging deformation.



Machine Foundation *The marked size has about 10mm error

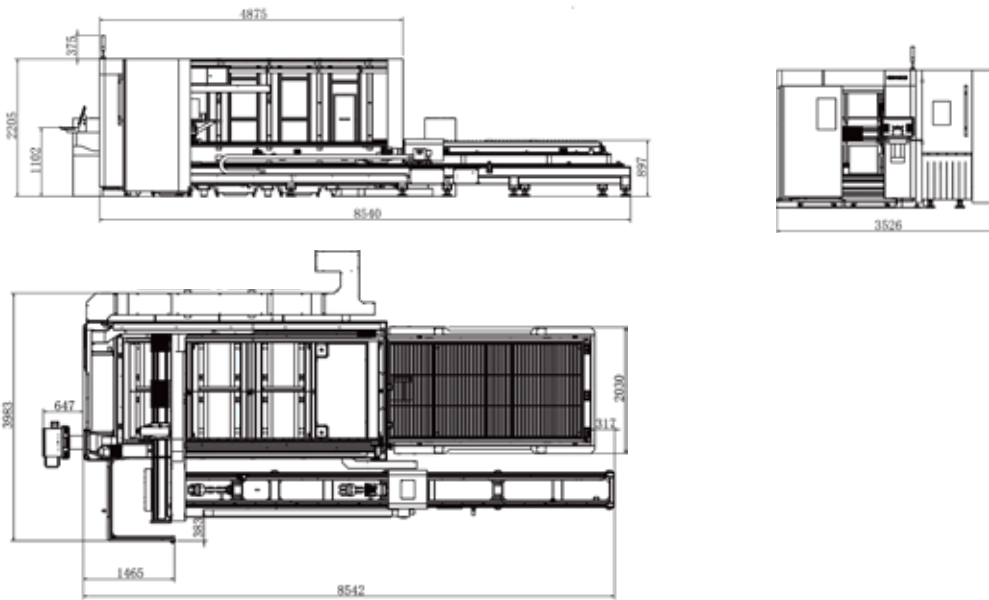

Cutting Samples

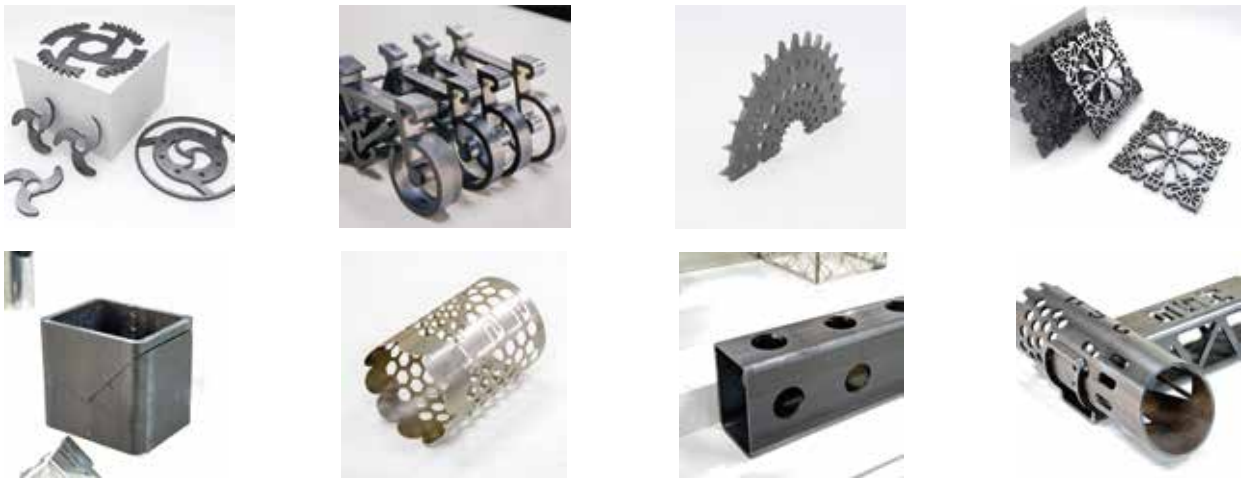

Cutting Capacity

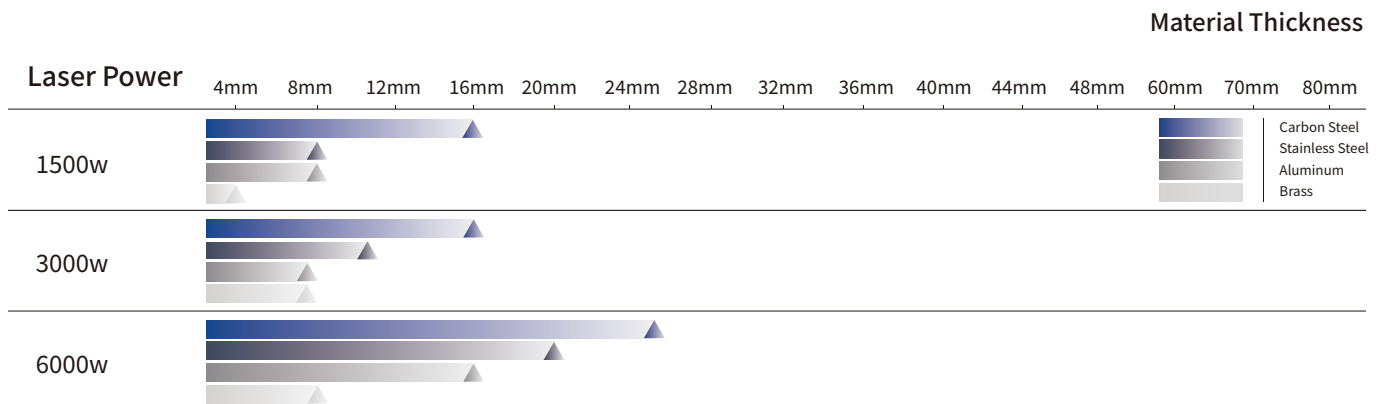

The actual machines shall prevail and above data & pictures are only for reference.



Intelligent Manufacturing Changes Future



As a global enterprise, HSG sticks to providing professional and convenient service support to customers at home and board



Professional Training

Multiple technical training service and free operation training for customers and dealers in time



Efficient Support

Humanistic service model, online services and 7*24 hotline to offer solutions and assistance



Optimized Transport

Multi-channel transport solutions and professional transport solution team will provide various transport cases for to satisfy the demand of customers and save transports fees



Sufficient Accessories

Highly efficient accessories delivery service, multiple network inventory jointly responds to accessories demand to shorten customer's waiting times and accelerate production



Careful Services

Domestic door-to-door service and free proofing, global 100+dealers provide efficient and convenient services



Intelligent Manufacturing Changes Future



Website



Facebook



Youtube

Headquarters Add.: No. 4, Anye Road, Shunjiang Community Industrial Park,
Beijiao Town, Shunde District, Foshan, Guangdong, China
Website: www.hsglaser.com
Email: info@hsglaser.com
Tel: +86 757-66833906